

Features

- Built-in 70V & 100V transformer
- 8" two way wall mount speaker
- Economy range speaker of excellent sound quality
- Power taps 5W, 10W, 20W, 40W & 80 at 100V output
- Both 100V and 8ohm outputs selector
- 360 degree rotatable mounting bracket is supplied
- Metal grille, ABS body and metal bracket
- Fashion speaker of black color

Description

The T-778P is a wall mount speaker built-in 70v/100v transformer. The 70v/100v transformer technique reduces line losses on longer distance and allows easy parallel connection of multiple loudspeakers.

The built-in 8"+2" two ways speaker driver is designed of wide frequency response 100-17kHz, , the multiple power taps 5W, 10W, 20W, 40W & 80W are helpful for different applications varies from room size and ambient noise surroundings.

The metal grille, ABS enclosure and stainless mounting bracket are of black color. Easy and secure wall mount installation through the supplied mounting kit.

It is ideal choice for industrial and commercial applications in hotel, school, office and factory where background music and paging is needed.



Specification

Model	T-778P
Power Taps @100V	5W, 10W, 20W, 40W, 80W
Power Taps @70V	2.5W, 5W, 10W, 20W, 40W
Impedance	Balck: Com Red: 2KΩ/1KΩ/500Ω/250Ω/125Ω/8Ω
SPL(1W/1M)	94dB
Max. SPL (Rated W/1M)	113dB
Frequency Response (-10dB)	100-17KHz
Finish	Baffle: ABS, Black/White Grille: Steel, Black/White
Speaker Driver	8"x 1 2" x 1
Dimensions	280 x 225 x375mm
Weight	6.2Kg
Mounting	With mounting bracket fixed by screw

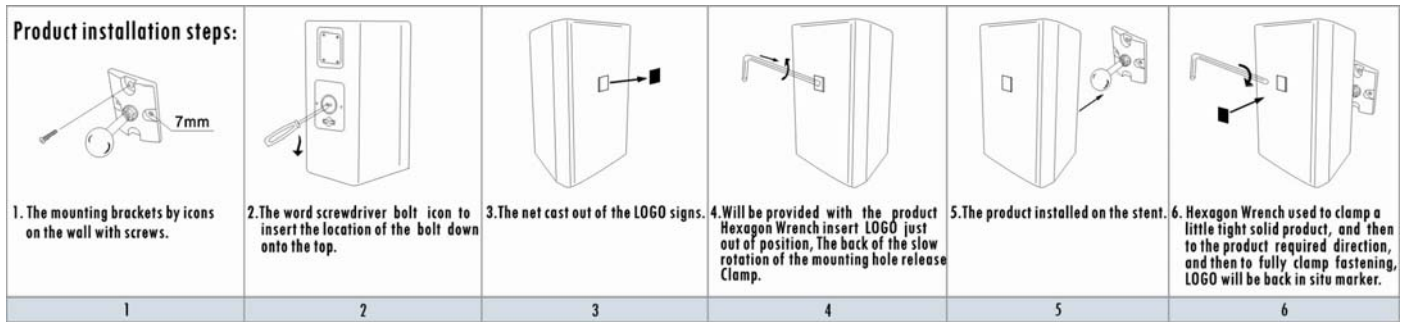
Appearance:

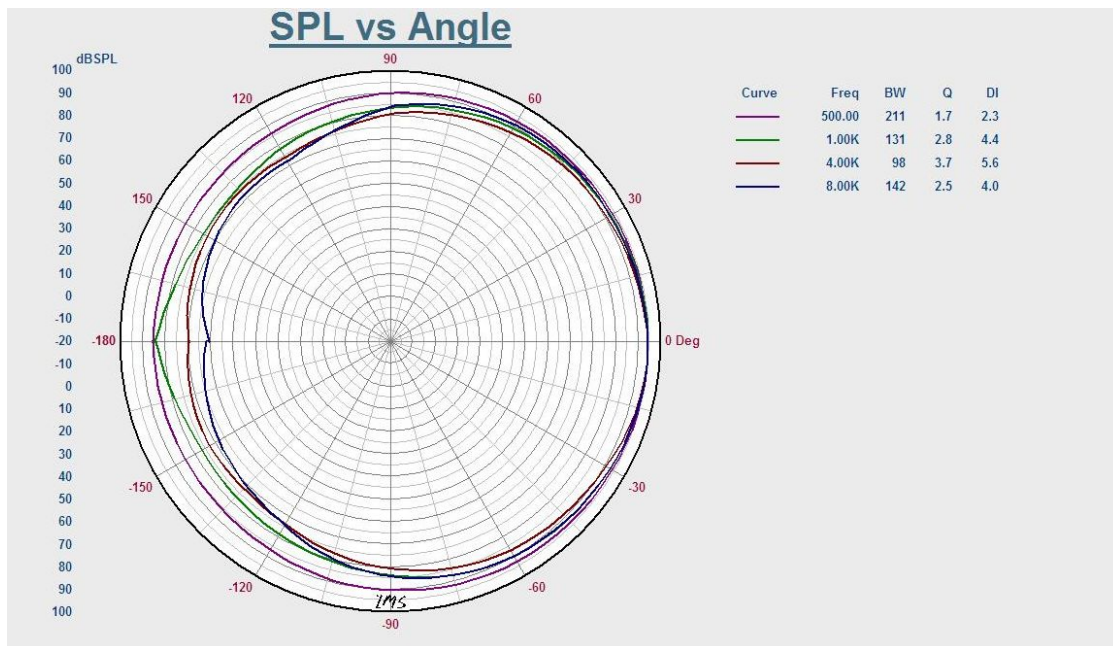

Direction Diagram:



Frequency Response:

